

CARGO CONTROL • TRUCK AND TRAILER HARDWARE



TRUCK & TRAILER HARDWARE



PART NO.	DESCRIPTION	SIZE	THICKNESS	DEPTH	WEIGHT
B2373G	Bolt-On Stake Pocket	3" x 1 1/2"	1/8"	2 1/8"	.7 lbs.
B2373C	Weld-On Stake Pocket	3" x 1 3/4"	1/4"	4"	2.5 lbs.
B2373J	Weld-On Stake Pocket	3" x 1 1/2"	1/4"	3"	2 lbs.
B2373K	Weld-On Stake Pocket	3" x 1 1/2"	1/4"	4"	2.5 lbs.
B2595	Spring Latch Assembly Zinc plated with 4 1/4" bolts	1/2"			.85 lbs.
B2596	Spring Latch Assembly Zinc plated with 4 1/4" bolts	3/4"			1.25 lbs.
B2585BZ	Straight Stake Rack Connector Set 7" overall length ,11/32"holes, formed from 2 1/2" x 3/16" stock One set consist of 4pieces. one L.H. pair (B2585BLH) and one R.H. pair (B2585BRH)				
B2591BZ	Corner Stake Rack Connector Set - Zinc 3 5/8" overall length ,11/32"holes, formed from 2 1/2" x 3/16" stock One set consist of 4pieces. one L.H. pair (B2591BLH) and one R.H. pair (B2591BRH)				
B2588BZ	Straight side security latch set - Zinc				1.5 lbs.
B2589BZ	Corner security latch set - - Zinc				1.5 lbs.
B2447BZ	Tarp Hook - 3 1/4" long, 9/32" holes, 3/8" round cross section, Zinc				
B2448B	Binding tarp hook- 5" long, 9/32" holes, 1/2" round cross section, Zinc				

LYNCH PINS

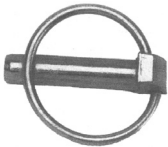

- Yellow Zinc plated.
- Packaged parts are two (2) pieces per clam shell

BULK PART NO.	PACKAGED PART NO.	SIZE
66000	66001	1/4"
66003	66004	3/16"
66006	66007	5/16"
66010	66011	7/16"

SNAPPER PINS

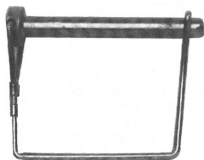

- Yellow Zinc plated.
- Packaged parts are two (2) pieces per clam shell

BULK PART NO.	PACKAGED PART NO.	SIZE	USABLE LENGTH	USABLE HEIGHT
66045	66046	3/16" X 1 3/4"	1 5/8"	1 1/2"
66050	66051	1/4" X 2"	1 3/4"	1 1/2"
66053	66054	5/16" X 2 3/4"	2 1/2"	1 5/8"
66056	66057	3/8" X 1 5/8"	1 1/2"	1 1/2"
66060	66061	3/8" X 2 1/2"	2 1/4"	1 1/2"
66063	66063	1/4" X 2 3/4"	2 1/2"	1 3/4"
66066	66067	1/4" X 3 1/4"	3"	1 1/2"
66070	66071	1/4" X 3 3/4"	3 1/2"	1 1/2"

HITCH PINS

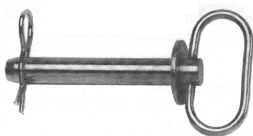

- Forged 1040 Steel
 Yellow Zinc plated spring
 wire handle
 Includes cotter pin

PART NO.	SIZE (Dia. x Usable Length)
66100	1/2" x 4 1/4"
66105	5/8" x 6 1/4"
66110	3/4" x 4 1/4"
66115	3/4" x 6 1/4"
66120	7/8" x 6 1/4"
66125	1" x 6 1/4"
66130	1 1/8" x 6 1/4"

CARGO CONTROL • TRUCK AND TRAILER HARDWARE



Universal Mounting Brackets are constructed of heavy duty 2" C-channel A-36 steel and are black E-coated for a corrosion resistance.

UNIVERSAL MOUNTING BRACKETS

Reversible retaining bars allow for multiple position mounting of each bracket. All mounting brackets are designed with a universal hole pattern for quick and easy mounting to the vehicle. Available in sizes 18" x 18" and 18" x 24"



PART NO.	SIZE	WEIGHT
1701005	18"x18"	16 lbs
1701010	18"x24"	18 lbs.



Chrome plated

DIE CAST GRAB HANDLES



PART NO.	DESCRIPTION	WEIGHT
B2399B2C	Chrome Die cast grab handle 8-1/4" end to end	.75 lbs.
B2399BC	Chrome tubular steel grab handle 11-1/2" end to end	.40 lbs.
B239920C	Chrome solid steel grab handle 16" end to end	1.00 lbs.



FOLDING FOOT OR GRAB STEP



PART NO.	DESCRIPTION	WEIGHT
B2797Z	Safety folding grab or step, zinc plated	1.25 lbs.
B2797SS	Same as above in stainless steel	1.25 lbs.



STAINLESS STEEL HEAVY DUTY STANDARD SIZE FLUSH MOUNT PADDLE AND "T" LATCHES

Designed to mount in a 3 3/8" x 4 5/8" recess



PART NO.	DESCRIPTION	WEIGHT
L3885	Single point latch (locking), stainless steel	1.15 lbs.
L3980	Single point latch (locking), rust resistant	1.15 lbs.
L8815	Single point folding "T" handle, stainless, mounts in 3 3/4" x 4" recess	1.25 lbs.
39LL71	Replacement Cylinder & Key for Std. Size Latches	0.09 lbs.



Interchanges with SOUTHCO #37-10-086-10

RUBBER HOOD LATCH



PART NO.	DESCRIPTION	WEIGHT
WJ195	4" "Easy Grip" Rubber Hood Catch w/Bracket	0.30 lbs.



ADJUSTABLE DRAW LATCH



PART NO.	DESCRIPTION	WEIGHT
WJ225	Adjustable Draw Latch - Zinc Plated Steel	0.78 lbs.



CERTIFICATE HOLDERS



Keeps permit or license clean and dry in any weather. Cam-on translucent cover has gasketed seal. High-impact plastic. Tension spring holds documents in place with cover removed.

PART NO.	DESCRIPTION	PKG
PET46	Round Certificate Holder - Screw on cap	Bulk
PET100	Round Certificate Holder - Press on cap	Bulk

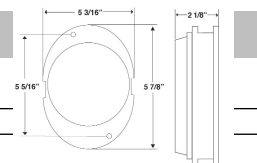

CARGO CONTROL • TRUCK AND TRAILER HARDWARE



VERTICAL MOUNT TRAFFIC CONE HOLDER

• Holds ten 18" cones or five 28" cones • Predrilled for vertical mount. Silver powder coat finish.



PART NO.	DESCRIPTION	WEIGHT
TCH10V	Traffic Cone Holder - 22" tall	2.25 lbs.

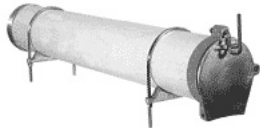

CONDUIT CARRIER KIT

Kit includes cast aluminum door and end cap, U-Bolt, and saddle bracket for use with 6" diameter PVC (not included). Door features spring loaded latching mechanism, padlock tab and rubber gasket for weather resistance. Adjustable from 41" to 72". 600 lb. capacity. White powder coat finish.



PART NO.	DESCRIPTION	WEIGHT
CC600	Conduit Carrier Kit	6.50 lbs.

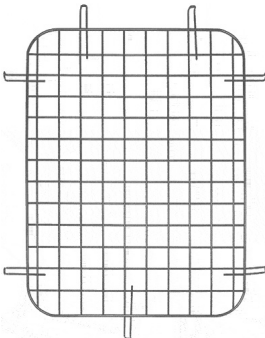

SECURITY WINDOW SCREENS

Set of two screen covers windows on rear hinged, side hinged or side sliding doors. (85310 is single screen to cover one-piece glass in Ford vans w/ side sliding doors). Fits Ford E-Series cargo vans, '92 & newer. Fits Chevy/GMC G-Series cargo vans, '96 & newer. Black powder coat finish.



PART NO.	DESCRIPTION	WEIGHT
85300	Security Window Screen Set (Ford), Rear Hinged	8.00 lbs.
85305	Security Window Screen Set (Ford), Side Hinged	8.00 lbs.
85310	Security Window Screen Set (Ford), Side Sliding	8.00 lbs.
85400	Security Window Screen Set (Chevy/GM), Rear Hinged	8.00 lbs.
85405	Security Window Screen Set (Chevy/GM), Side Hinged	8.00 lbs.
85410	Security Window Screen Set (Chevy/GM), Side Sliding	8.00 lbs.

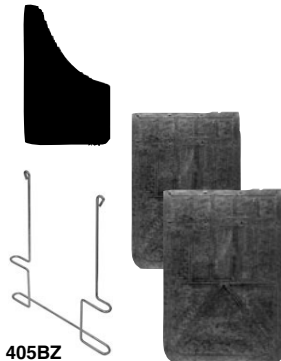

MUDFLAPS AND FENDER GUARDS

Buyers Heavy-Duty rubber splash guards are produced with all rubber for greater strength and longer wear. These splash guards are available in a variety of sizes to fit most trucks and trailers. Withstands subfreezing temperatures. Resists buildup of ice and snow. Repels impact from road debris.



PART NO.	DESCRIPTION	WEIGHT / PAIR
B2018LSP	20" x 18" - 1/4" Thick Rubber Mudflaps (pair)	7.00 lbs.
B30LP	24" x 30" - 1/4" Thick Rubber Mudflaps (pair)	14.00 lbs.
B36LP	24" x 36" - 1/4" Thick Rubber Mudflaps (pair)	16.00 lbs.
405BZ	Galvanized, 21-1/8"H x 26-3/8"W Anti-Sail Brackets (pair)	4.45 lbs.
B1018PPB	18"L x 10"W Black Polymer Fender Splash Guard (pair)	1.00 lbs.
RC36PPB	36"L x 24"W Black Polymer Fender Splash Guard (pair)	3.00 lbs.
B1237PPB	37"L x 12"W Black Polymer Fender Splash Guard (pair)	3.00 lbs.



NATIONAL FLEET PRODUCTS • POLY TRUCK & TRAILER FENDERS

Polyethylene material simply lasts longer than any other product. It's extremely durable, impervious to salt and holds up in 100° F below zero to 197° F above zero. They cover wheels completely and are particularly useful on multi-axle applications -- when dented or crushed they bounce back to shape. Every fender has a unique lip that provides for superior control of water spray.



- **Never needs paint---**Color is molded throughout so chips, scuffs and scratches can't be seen.
- **Never fades---**UV inhibitors are built into the material.
- **Never rusts---**Material is 100% polyethylene.
- **Never stress cracks---**This unique material is not affected by road vibration.
- **Never needs polishing---**Simply clean with soap and water.

VARIOUS FENDER STYLES, COLORS & MOUNT BRACKETS ARE AVAILABLE - CALL R.H. SCALES TODAY!